



Smoke and Fire Curtains

SMOKE CURTAIN FIXED DRAFT CURTAIN SM-ST

A Fixed Draft Smoke Curtain contains smoke and heat in the case of fire.

Per NFPA 92B, Draft curtains are generally used to channel or contain smoke that is attached to the underside of the ceiling and protrude a limited distance downward.

Fire resistance



60 minutes

120 minutes



Smoke and Fire Curtains

KEY FEATURES



Smoke tightness tests

Materials class: **A2-s1, d0**

Quality of cloth

1700°F Glass fabric

1850°F Glass fabric with coating and stainless-steel inlay

PRODUCT DESCRIPTION

The purpose of a Draft Smoke Curtain is to contain the movement of heat and smoke within a building.

The Draft Curtain consists of several overlapping curtains attached together to provide a continuous run. They are connected together and to the building by means of clamps and angle pieces.

The installation angles and the clamping profiles are predrilled to accept rivets. The connecting pieces have a continuous predrilled hole pattern, enabling fast and easy assembly of the curtain fabric. The bottom bar has a loop to accommodate the weight.

The Draft Curtain system can be used to close off a scheme of movable smoke curtains position below it, by clamping directly onto the housing of the movable smoke curtain.

Fixing brackets, clamping profiles and bottom bars are all in galvanized steel.

The curtain overlaps can be attached to one another using a spray adhesive approved by MPA Stuttgart, which seals the flaps tightly to enhance the appearance of the surface of the curtain.

The system is fixed to the building with approved fasteners at intervals of a maximum of 5 feet.

TESTING / CERTIFICATES

EC Certificate of Conformity 0672 – CPD
0146 time/temperature classification D 120
0206 time/temperature classification DH 60
0207 time/temperature classification DH 120

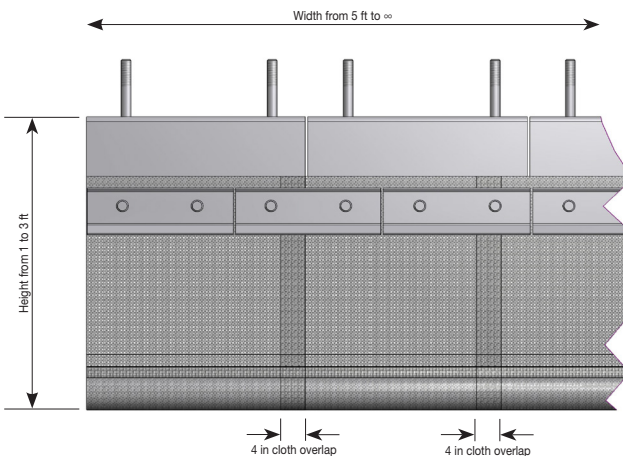
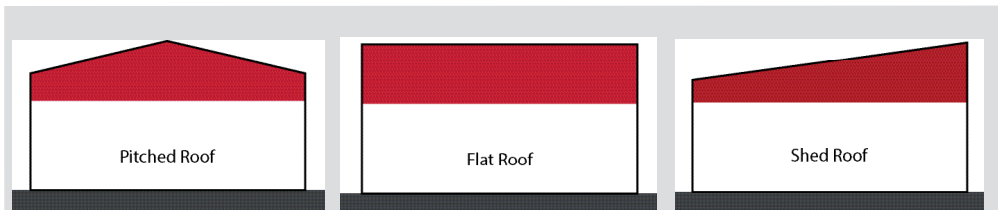

Lightweight compared to alternative materials such as steel sheeting

- Assist the emergency services by containing or channelling the smoke into predetermined areas.
- Limit travel and overcooling of smoke, reducing the risk of cold smoke dropping to low level and obscuring vision.
- Its prefabricated metal sleeves allow penetrations to be made in various sizes and shapes.



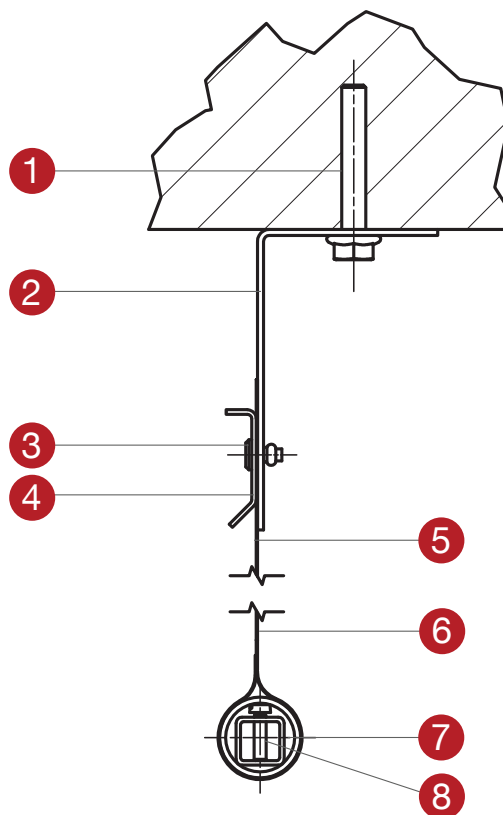
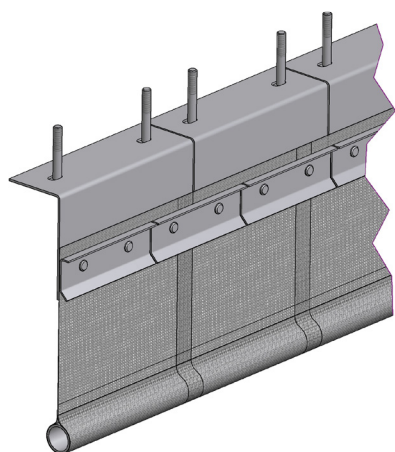
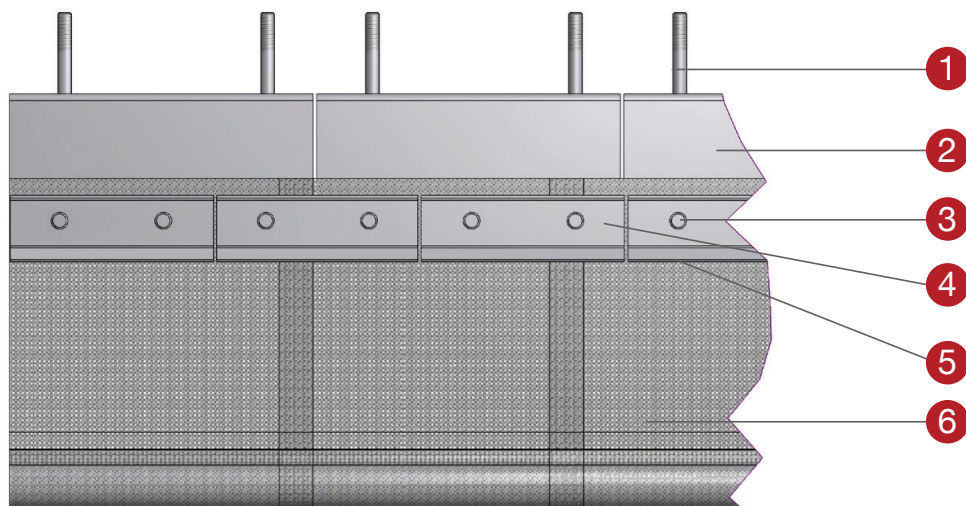

- 1 Fixing Anchor
- 2 Angle Profile
- 3 Rivet
- 4 Clamp Profile
- 5. "Duo" adhesive tape
- 6. Smoke Curtain Cloth
- 7. Galvanized Steel Bar
- 8. Coupling Piece